

# Electric Latch • USER MANUAL

## Electric Latch and Stopper

electric latch is used to lock the gate and it has to be used with stopper and installed on the master gate.

| List of small parts for Electric Latch and Stopper | Quantity |
|--|----------|
| M8*25L hex bolt                                    | 3 pcs    |
| M8 self-locking nut                                | 3 pcs    |
| Key  | 2 pcs    |

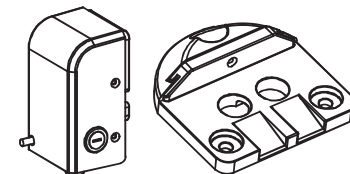

### Electric Latch

|                              |                       |
|------------------------------|-----------------------|
| <b>Application</b>           | For locking the gate. |
| <b>Power Supply</b>          | 220V AC               |
| <b>Operating Temperature</b> | -20°C ~ +50°C         |
| <b>Operating Current</b>     | 5A                    |
| <b>Dimension</b>             | 61mm * 55mm * 120mm   |

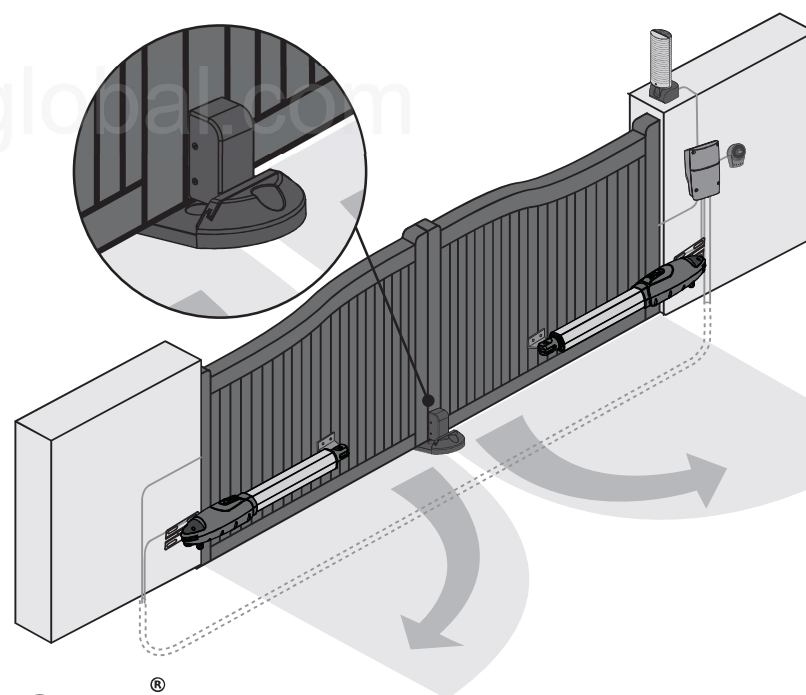

**AUTOGLIDE®**

CE

## Electric Latch and Stopper

### 1. Stopper:

- Before installing the stopper, please make sure the gates are in close positions and the surface to be installed is flat.
- Place the stopper on the ground using the bottom as reference, and mark the 3 drilling points.  
See Figure (1) For the gate opened inward.  
See Figure (2) For the gate opened outward.

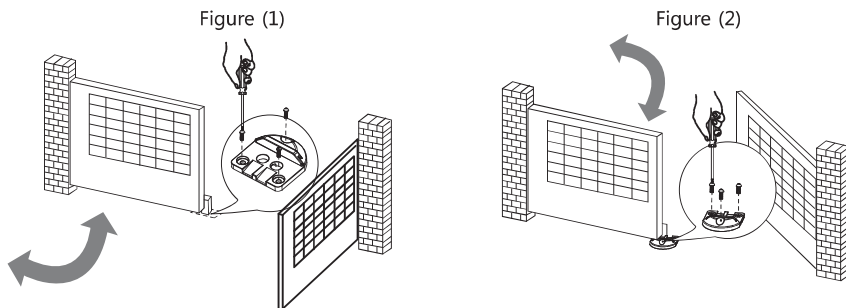

Note: If the gate is opened outward, place the stopper in opposite direction.

- Drill the 3 marked points, and then securely attach the stopper to the ground with screws and washers.  
See Figure (3)

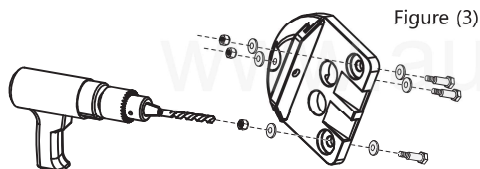

### 2. Electric Latch:

(If the gate is opened outward)

- If the gate is opened outward, please change the spring inside and screw it in the different place.  
See Figure (4), Figure (5), Figure (6) & Figure (7)

Figure (4) Unscrew the screws.

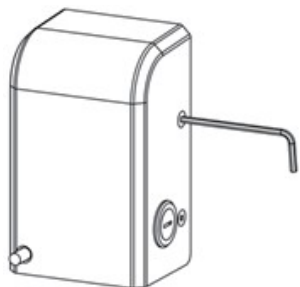

Figure (5) Take the casing off.

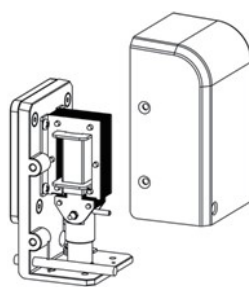

Figure (6)  
The location of the spring.

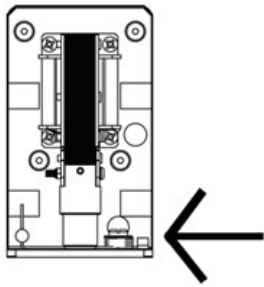
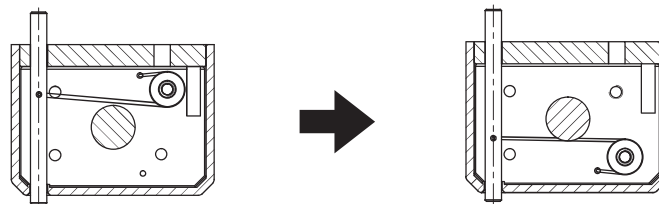

Figure (7)

Change the spring and screw it in the different place.

(Installation)



- Weld the back plate of the electric latch to the surface on the master gate. See Figure (8).  
Please avoid melting the wires by the heat of the fixed plate.

Figure (8) For the gate opened inward.

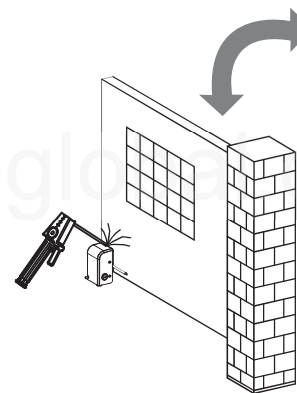
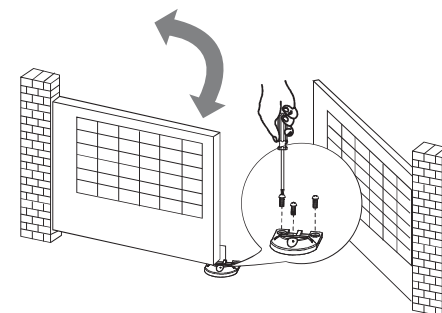

Figure (9) For the gate opened Outward.



- The gap between the bottom of electric latch and the stopper should be less than 7mm. See Figure (10)

Figure (10) For the gate opened inward.

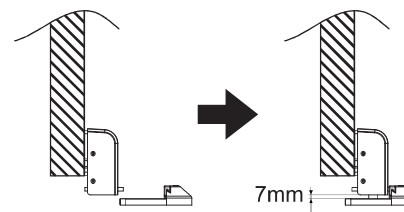
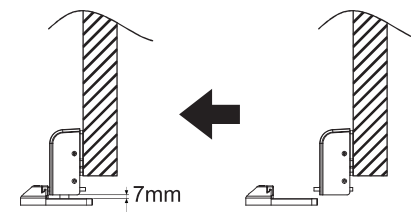

Figure (11) For the gate opened Outward.



- Connect the wires of the electric latch to the terminal LAT(+) and LAT(-) on the PCB.